

Safety Instructions

Please read these safety instructions carefully before use and keep them for future reference.

Intended Use

- Use the electric power cleaning nozzle only with suitable Lux vacuum cleaners.
- Use only for dust and dry materials. Never vacuum people or animals with the electric power nozzle. Any other usage, modifications or changes are not permitted.
- This appliance can be used by children aged 8 or over and persons with reduced physical, sensory or mental capabilities or lack of experience and knowledge if they are supervised when using or have received instructions for using the machine safely and understand the possible dangers.
- Children should not play with this device. The cleaning and maintenance must not be carried out by children unless supervised by an adult.

Technical Safety

- Always ensure the machine is switched off and is disconnected from the electricity supply before any changes, cleaning or maintenance

are carried out.

- Operate the unit only in accordance with this manual.
- Check before operating whether the voltage indicated on the bottom of the device matches the local mains voltage.
- Do not use the machine if it is damaged. Ensure that any damaged parts are only replaced by authorised Lux Service personnel.
- Do not immerse the machine in water and only use a dry or slightly damp cloth to clean the motor brush.

Correct Use

- Do not use for hot or burning materials such as cigarettes or ashes.
- Do not use on liquids and damp materials.
- Do not use on easily flammable or explosive materials or gases.
- Be careful that hair, fingers, clothing and the like never come in contact with the rotating roller of the electric power cleaning head.
- Never touch the brush roller while the vacuum cleaner is connected to the mains.
- Never push the electric power cleaning head

over the mains supply cable as the cable could be damaged.

Warranty Note

- The warranty and extended warranties are only valid if Lux ORIGINAL spare parts, accessories and consumables are used.
- Repairs during the warranty period must be performed by authorized Lux Service personnel.

The manufacturer reserves the right to make changes to the product described in this manual at any time without prior notice.



This symbol on the product or packaging indicates that this product must not be disposed of with normal household waste within the EU. In order to avoid possible negative consequences for the environment and health caused by improper waste disposal, please recycle this product responsibly in order to support the sustainable reuse of materials used in the construction. To return your used product safely, please use a designated recycling collection point or contact the dealer from whom the product was purchased.

Get Started

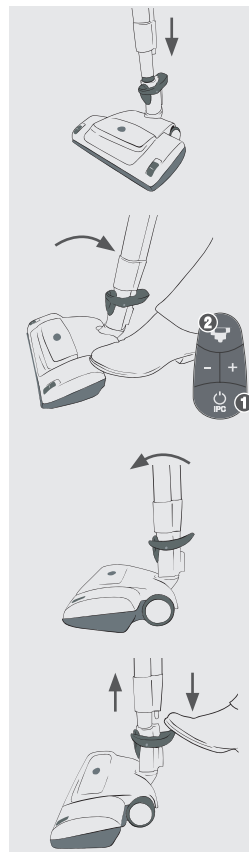

Connecting the Motor Brush

Insert the telescopic tube vertically into the PB Intelligence Motor Brush. Ensure that the tube clicks audibly into place.

Switching on the Motor Brush

Release the motor brush from the standby-position by lightly touching the nozzle with your foot and pulling the tube backwards. Turn on the vacuum cleaner. Turn on the motor brush by pressing the motor brush symbol. 1

Standby-Position

The motor brush stops automatically when the tube is tilt to vertical position. It will automatically restart when the tube is tilted backwards again.

Disconnecting the Motor Brush

Disconnect the motor brush by lightly pressing down the foot pedal and pulling out the telescopic tube.

Functions and Settings

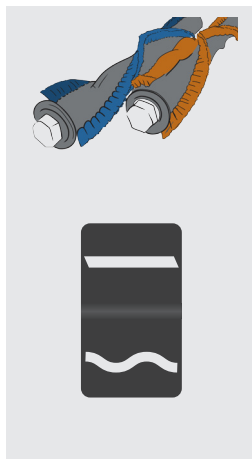

Brush Rolls*

Your PB Intelligence can work with two different brush rolls.

The **PowerClean Plus** brush is specifically designed for hard floors.

The **SensiClean Plus** brush has softer bristles and is ideal for the deep cleansing of sensitive floors.

Automatic Roller Adjustment

The automatic roller adjustment guaranties the optimal contact pressure of the brush roller to your respective floor.

For a powerful deep cleansing, you can set the brush roll on the maximum level.

*One brush roll is included in the package, please inquire locally about the optional one.

Note

IMPORTANT

Not all carpets and hard floors are suitable for cleaning with a brush motor. If in doubt, contact the manufacturer or dealer of your floor covering.

Viewing Window

The viewing window of the brush roller can become dull with time. Please remove fibres and hair from the brushes regularly to avoid overheating.

Automatic Roller Adjustment

Always move the two roller adjustment slides with both hands simultaneously.

Suitability of the Motor Brush for Floors

Applies to undamaged, well preserved floors and carpets.

	Floor Type	PowerClean Plus	SensiClean Plus
Carpets	Velour	++	+
	Loop Piling	++	+
	Berber	-	+
	Sisal	-	++
	Loose Carpets	-	++
	Long Pile Carpets	-	+
	Silk	-	0
	Loose Knotted Carpets	-	-
	Shag Pile, Fur	-	-
	Sealed Wooden Floors (e.g. Parquet, Floorboards)	0	++
Hard floor	Laminate	0	++
	Oiled Wooden Floors (e.g. Floorboards, Parquet)	-	+
	PVC, Linoleum, CV	-	+
	Smooth Natural Stone Floors	-	+
	Clay Floors	-	0
	Ceramic Tiles	+	++
	Sealed Cork Floors	-	+
	Unsealed Cork Floors Rough	-	-
	Sensitive Natural Stone Floors	-	-
	Unsealed Wooden Floors	-	-
	Concrete Floors	-	-

++ : ideally suited, + : well suited, 0 : partially suited, - : not suited

Use on Carpet and Textile Floors

Please check whether and in what setting the motor brush is suitable for your floor type. (See „Suitability of the Motor Brush for Floors“)

On carpeting or similar material, move the motor brush back and forth with slow movements. On carpets with fringes, ensure you never brush the fringe.

For delicate carpets or similar materials, we recommend you use the soft **SensiClean Plus** brush roller (see section „Changing and Cleaning the Brush Roller“)

Use on Hard Floors

Please check whether and in what setting the motor brush is suitable for your floor covering. (See „Suitability of the Motor Brush for Floors“)

For smooth, hard floors, we recommend you use the **SensiClean Plus** Brush Roller. Move the motor brush slowly and evenly back and forth.

Note

- We recommend you always use the vacuum cleaner in automatic mode.
- Never leave the PB Intelligence working for any length of time in one place as this may damage the floor.
- To avoid injury or damage, the PB Intelligence has an automatic switch off function. If something gets drawn in and blocks the brush, the motor brush automatically switches off. To remove whatever item is causing the blockage, disconnect the motor brush from the power supply! After you have removed the blockage, just switch on the motor brush again.

Changing and Cleaning the Brush Roller

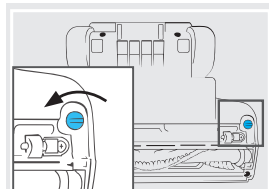

Removing the Brush Roller

Disconnect the motor brush from the power supply.

Turn the blue dial and remove the locking device.

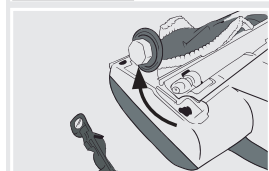

Lift the brush roller slightly and pull the brush roller from the suction channel.

Remove any dirt, dust or hair from the moving parts of the nozzle.

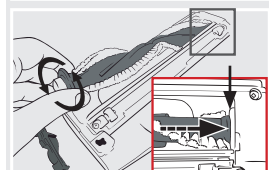

Inserting the Brush Roller

Insert the open gear end of the brush roller into the suction channel with a slight twisting motion and push it down until it clicks into place.

Re-insert the locking device with a slight tilt backwards and turn the blue dial back to the locking position.

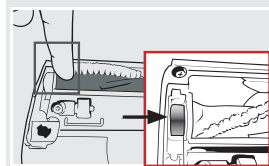

If the locking device won't close, the brush roller has not been correctly inserted.



Cleaning the Brush Roller

Please remove any dirt, dust or hair from the brush roller regularly.